

Sandwich pressure regulator with manual adjust.

OPERATIONAL BENEFITS

1. Easy mounting : saves on installation costs in comparison with inline regulators.
2. Allows to have compact, all-included units.
3. Large orifice provides high flow.
4. Various functions available.
5. Simple, reliable and solid design.



Reset

HOW TO ORDER

REGULATORS FOR INTERNAL PILOT APPLICATIONS

Gauges	Single pressure Regulator 14 end Same regulated pressure to ports 2 and 4	Single pressure Regulator 12 end Same regulated pressure to ports 2 and 4	Dual pressure Regulator 14 end Regulated pressure to port 4 *	Dual pressure Regulator 12 end Regulated pressure to port 2 *	Dual pressure Dual regulator Two regulated pressures to ports 2 and 4 *
No gauge	PRA3B-1AAA	PRA3B-1EAA	PRA3B-1BAA	PRA3B-1FAA	PRA3B-1JAA
With gauge	PRA3B-1ADA	PRA3B-1EDA	PRA3B-1BDA	PRA3B-1FDA	-----
Two gauges	-----	-----	PRA3B-1BEA	PRA3B-1FEA	PRA3B-1JEA

REGULATORS FOR EXTERNAL PILOT AND REMOTE AIR APPLICATIONS

Gauges	Single pressure Regulator 14 end Same regulated pressure to ports 2 and 4	Single pressure Regulator 12 end Same regulated pressure to ports 2 and 4	Dual pressure Regulator 14 end Regulated pressure to port 4 *	Dual pressure Regulator 12 end Regulated pressure to port 2 *	Dual pressure Dual regulator Two regulated pressures to ports 2 and 4 *
No gauge	PRA3B-2AAA	PRA3B-2EAA	PRA3B-2BAA	PRA3B-2FAA	PRA3B-2JAA
With gauge	PRA3B-2ADA	PRA3B-2EDA	PRA3B-2BDA	PRA3B-2FDA	-----
Two gauges	-----	-----	PRA3B-2BEA	PRA3B-2FEA	PRA3B-2JEA

* - To be used with dual pressure valves.
 - Valve code is : MV-A3B-AX5X-PM-XXYYZ

**TECHNICAL
 DATA**

Fluid :	Compressed air, inert gases
Pressure range :	0 to 10 bar
Regulating range :	0.5 to 8.5 bar
Lubrication :	Not required, if used select a medium aniline point lubricant (between 80°C and 100°C)
Filtration :	40 µ
Temperature range :	-18°C to +50°C
Flow (at 6 bar, ΔP=1bar) :	5400 NI/min (C _v 5.4)

Spare parts : • Pressure regulator : PRA3B-30AA.

DIMENSIONS

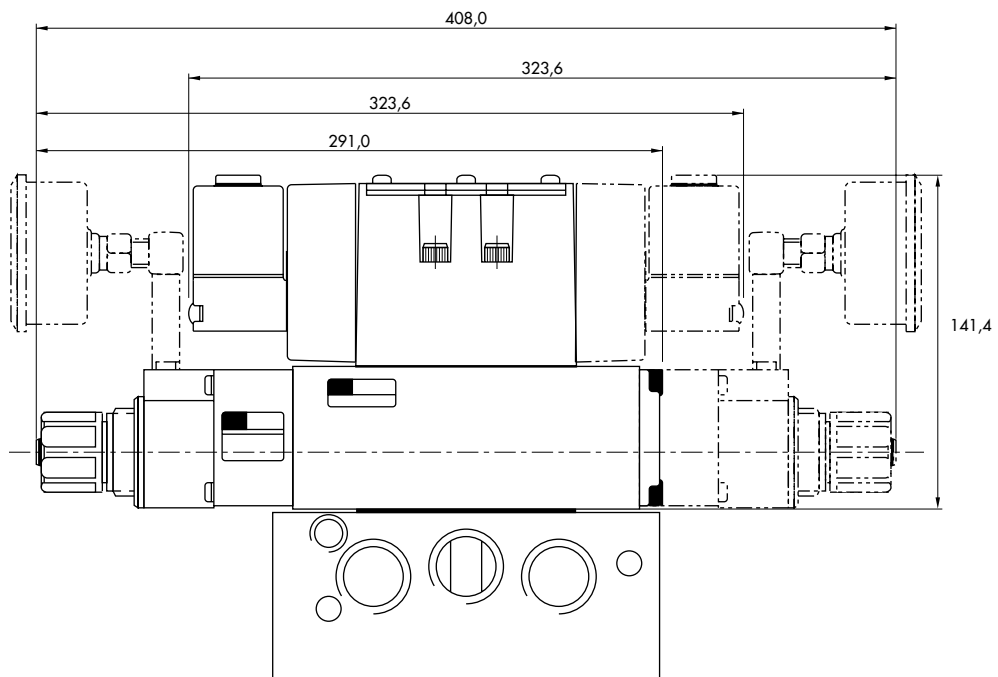

Sandwich pressure regulator with air adjust.

OPERATIONAL BENEFITS

1. Easy mounting : saves on installation costs in comparison with inline regulators.
2. Allows to have compact, all-included units.
3. Large orifice provides high flow.
4. Various functions available.
5. Simple, reliable and solid design.



HOW TO ORDER

Reset

REGULATORS FOR INTERNAL PILOT APPLICATIONS

Gauges	Single pressure Regulator 14 end Same regulated pressure to ports 2 and 4	Singola pressione. Regolatore lato 12. Regolazione utilizzi 2 e 4	Dual pressure Regulator 14 end Regulated pressure to port 4 *	Dual pressure Regulator 12 end Regulated pressure to port 2 *	Dual pressure Dual regulator Two regulated pressures to ports 2 and 4 *
No gauge	PRA3B-4AAA	PRA3B-4EAA	PRA3B-4BAA	PRA3B-4FAA	PRA3B-4JAA
With gauge	PRA3B-4ADA	PRA3B-4EDA	PRA3B-4BDA	PRA3B-4FDA	-----
Two gauges	-----	-----	PRA3B-4BEA	PRA3B-4FEA	PRA3B-4JEA

REGULATORS FOR EXTERNAL PILOT AND REMOTE AIR APPLICATIONS

Gauges	Single pressure Regulator 14 end Same regulated pressure to ports 2 and 4	Singola pressione. Regolatore lato 12. Regolazione utilizzi 2 e 4	Dual pressure Regulator 14 end Regulated pressure to port 4 *	Dual pressure Regulator 12 end Regulated pressure to port 2 *	Dual pressure Dual regulator Two regulated pressures to ports 2 and 4 *
No gauge	PRA3B-5AAA	PRA3B-5EAA	PRA3B-5BAA	PRA3B-5FAA	PRA3B-5JAA
With gauge	PRA3B-5ADA	PRA3B-5EDA	PRA3B-5BDA	PRA3B-5FDA	-----
Two gauges	-----	-----	PRA3B-5BEA	PRA3B-5FEA	PRA3B-5JEA

* - To be used with dual pressure valves.
 - Valve code is : MV-A3B-AX5X-PM-XXYYZ

**TECHNICAL
 DATA**

Fluid :	Compressed air, inert gases
Pressure range :	0 to 10 bar
Regulating range :	0.5 to 8.5 bar
Lubrication :	Not required, if used select a medium aniline point lubricant (between 80°C and 100°C)
Filtration :	40 µ
Temperature range :	-18°C to +50°C
Flow (at 6 bar, ΔP=1bar) :	5400 NI/min (C _v 5.4)

Spare parts : • Pressure regulator : PRA3B-60AA.

DIMENSIONS

